



241515 / 20 / 30

Description

Housing - Die cast aluminium powder coated with choice of RAL colors, radiation protection, UV with high mechanical resistance.

Diffuser - Tempered glass diffuser, UV stabilized with a better light output.

Reflector - Aluminium reflector, UV stabilized.

Type - LED Surface / Spike.

Standards - Manufactured and tested as per EN 60598-1 and 60598-2-1.

LED - Energy saving consumption and Durability. Efficiency and quality in wide variation. 50,000 Hrs Life span under temperature (-20°C to 55°C).

Objective

High resistance fitting that assured durability according to its uses. Provides highly efficient LED performances yet saves consumption. This is best for gardens, external uses and etc. LED energy consumption savings with durability and luminaire with efficiency. Completely dustproof. Protected against high pressure water jets.

Obiettivo

Montaggio ad alta resistenza che garantisce una lunga durata in base ai suoi usi. Fornisce prestazioni LED altamente efficienti ma risparmia i consumi. Questo è il migliore per giardini, usi esterni e così via. Risparmio di consumo energetico a LED con durata e apparecchi con efficienza. Completamente antipolvere. Protetto contro i getti d'acqua ad alta pressione.



CODE	POWER	CHIP	IP	LUMENS	DIMENSION
241515	15W	COB	66	100 lm/W	Ø180mm
241520	20W	COB	66	100 lm/W	Ø180mm
241530	30W	COB	66	100 lm/W	Ø180mm

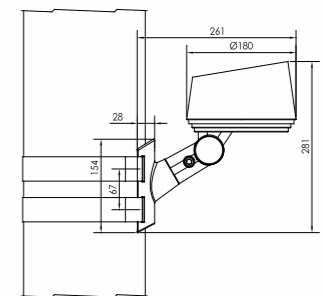
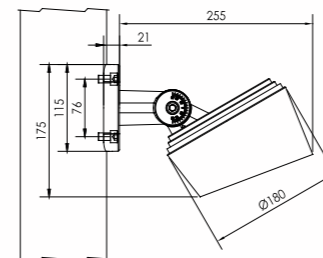
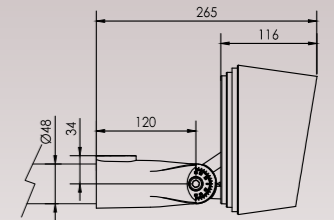
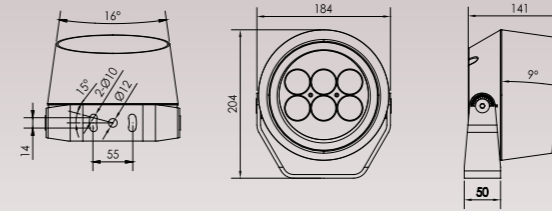
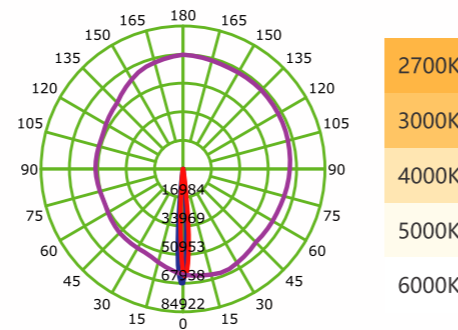
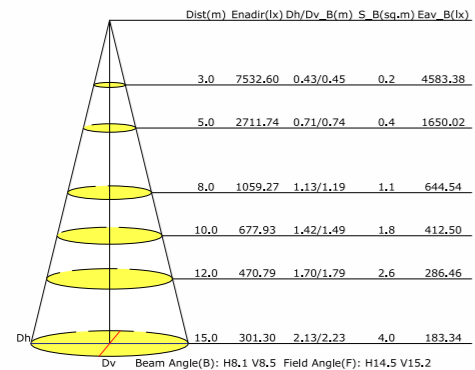

AVL Dia of pole(67-325)mm T≥4

AVL Dia of pole(168-268)mm

